

# Site risk assessment record

Berkshire  
Buckinghamshire  
Oxfordshire



<b>Location:</b> Loddon Nature Reserve	<b>Date of assessment:</b> 18/05/2018	<b>Nearest postcode:</b> RG10 9RR	<b>Main entrance OS Grid Ref :</b> SU 78395 76008
---	--	--------------------------------------	--

Hazards/hazardous events	Who is affected?	Typical outcome	Precautions	Risk Level LxH=RL
Uneven ground due to roots, stones, holes and muddy paths causing slips, trips or falls.	Public. BBOWT workers	Bruises, sprains, minor cuts and grazes.	<ul style="list-style-type: none"> <li>Maintain path surface.</li> </ul>	Likely x Slight harm = <b>slight</b>
A number of boardwalks across the site, resulting in slips, trips and falls.	Public. BBOWT workers	Bruises, sprains, minor cuts and grazes. Possibly broken bones.	<ul style="list-style-type: none"> <li>Regularly check steps and boardwalk condition, including timber and wire.</li> <li>Repair as necessary.</li> </ul>	Unlikely x harmful = <b>slight</b>
Thorny bushes along paths and in work areas.	Public. BBOWT workers	Cuts and grazes. Infections. Puncture wounds, eye damage.	<ul style="list-style-type: none"> <li>Ensure paths are kept clear.</li> <li>Provide safety glasses if working in thorny area.</li> </ul>	Likely x harmful = <b>moderate</b>
Falling dead wood in the form of either branches or trees.	Public. BBOWT workers	Head injuries, broken limbs, cuts and bruises.	<ul style="list-style-type: none"> <li>Conform to COP 31 and carry out tree safety assessments and remedial work required.</li> <li>Areas used/worked in are to be checked for dangerous trees.</li> <li>No work should be carried out in high winds.</li> </ul>	Unlikely x harmful = <b>slight</b>
Irritable and poisonous plants such as berries and fungi.	Public. BBOWT workers	Poisoning from ingestion.	<ul style="list-style-type: none"> <li>Do not eat fungi, berries or other plant material.</li> <li>Wash hands after handling such material.</li> </ul>	Unlikely x very harmful = <b>moderate</b>
Stings from bees, wasps or hornets.	Public BBOWT workers	Allergic reaction to stings.	<ul style="list-style-type: none"> <li>Be aware of any nests close by and do not get too close.</li> <li>All volunteers / staff should declare any known allergic reactions.</li> </ul>	Unlikely x harmful = <b>slight</b>

	Slight harm	Harmful	Very harmful
Unlikely	Trivial	Slight	Moderate
Likely	Slight	Moderate	Substantial
Very likely	Moderate	Substantial	Intolerable

Dog faeces.	Public. BBOWT workers	Stomach upset from bacteria in faeces. Toxocarias (an infection of the round worm <i>Toxocara cani</i> ). Young children are at particular risk due to their weaker immune systems and greater chance of exposure.	<ul style="list-style-type: none"> <li>Wear gloves if likely to come in contact with faeces.</li> <li>Wash hands before eating.</li> </ul>	Likely x Slight harm = <b>slight</b>
Litter/fly tipping.	Public. BBOWT workers	Cuts, infections.	<ul style="list-style-type: none"> <li>Use gloves/litterpickers when collecting rubbish and strong bags.</li> <li>Do not overfill.</li> <li>Contact staff if needles or syringes found, for advice on disposal in sharps containers.</li> </ul>	Unlikely x slight harm = <b>minor</b>
Water bodies.	Public. BBOWT workers	Drowning.	<ul style="list-style-type: none"> <li>Access (including swimming and boating) to water bodies (lake and river) to be discouraged.</li> <li>Route path away from edge of water body.</li> <li>Monitor bridge condition. Refer to CoP 32 and water feature risk assessment.</li> <li>Carry out additional assessment should conditions change.</li> </ul>	Unlikely x very harmful = <b>moderate</b>
Flooding.	Public. BBOWT workers	Drowning.	<ul style="list-style-type: none"> <li>Do not walk through fast flowing water following flooding incidents.</li> <li>Close site if required. Refer to CoP 32 and water feature risk assessment.</li> <li>Carry out additional assessment should conditions change.</li> </ul>	Unlikely x very harmful = <b>moderate</b>
Contact with water.	Public. BBOWT workers	Weil's disease (Leptospirosis).	<ul style="list-style-type: none"> <li>Cover cuts and abrasions and wash hands after contact with water.</li> <li>If flu like symptoms develop within 3-19 days after contact with water visit doctor and inform of the possibility of Weils' disease.</li> </ul>	Unlikely x very harmful = <b>moderate</b>
Blue-green algae	Public. BBOWT workers	Poisoning following ingestion of water.	<ul style="list-style-type: none"> <li>The site has the potential to be affected with blue-green algae.</li> <li>Do not drink the water and avoid skin contact.</li> <li>During visits in summer ensure staff are aware of signs to look out for.</li> <li>If blooms occur inform public with notices and seek guidance from Environment Agency.</li> </ul>	Unlikely x very harmful = <b>moderate</b>

	Slight harm	Harmful	Very harmful
Unlikely	Trivial	Slight	Moderate
Likely	Slight	Moderate	Substantial
Very likely	Moderate	Substantial	Intolerable

Hogweed.	Public. BBOWT workers	Blisters from a photosensitive skin reaction.	<ul style="list-style-type: none"> <li>Avoid contact with plant especially when cutting. Wear gloves.</li> <li>Keep paths clear of the plant.</li> </ul>	Unlikely x slight harm = <b>minor</b>
Unauthorised motor vehicle (motocross bikes)	Public BBOWT workers	Collision between pedestrians and motorbike/ confrontation situation	<ul style="list-style-type: none"> <li>Report to police; inform public of risk when alerted (via onsite signage).</li> <li>Restrict motorcycle access if problem persists. Vigilance when on site.</li> <li>Avoid any confrontations directly.</li> </ul>	Unlikely x very harmful = <b>moderate</b>

<b>Nearest telephone (landline):</b> Neighbouring properties	<b>Emergency telephone number</b> 999 or 112			
<b>Nearest A&amp;E department:</b> Royal Berkshire Hospital, London Road, Reading, Berkshire, RG1 5AN  Tel: 0118 322 5111	<b>Type of access for emergency services (delete as appropriate)</b> Pedestrian 2WD ( Limited 4WD)	<b>Access point/route for emergency services from road:</b> Parking for 2WD vehicles next to Wagon and Horses Public House, off the A3032. Pedestrian access across the bridge onto the nature reserve.		
<b>Assessment undertaken by:</b> Simon Barnett	<b>Position:</b> Berks L M (People & Estates)	<b>Manager confirming assessment:</b> Alex Cruickshank	<b>Date for revision:</b> March 2019	

Work identified from site risk assessment	By whom	Date completed

	Slight harm	Harmful	Very harmful
Unlikely	Trivial	Slight	Moderate
Likely	Slight	Moderate	Substantial
Very likely	Moderate	Substantial	Intolerable

This checklist is designed to assist in the production of Site Risk Assessments. For those hazards present, more specific information should be provided, e.g. location within site and precautions required entered on SRA form. **This list is not comprehensive. Map is located in reserves office.**

No.	Risk	Present		Recorded on map
		yes	no	
1	Steep slopes and banks	yes	no	
2	Drowning risk – deep water [pools, streams, rivers]	yes	no	Yes
3	Fall hazards – rock outcrops, buildings, building foundations	yes	no	
4	Areas liable to flooding	yes	no	
5	Areas of permanent soft ground	yes	no	Yes
6	Areas of soft ground following rain	yes	no	
7	Uneven path / track surfaces	yes	no	Yes
8	Uneven ground	yes	no	
9	Remote areas	yes	no	
10	Dry weather fire hazard – heath, scrub, grass	yes	no	
11	Sun exposure – poor shade - burn / dehydration	yes	no	
12	Site used for walking [Inc dogs]	yes	no	
13	Children playing	yes	no	
14	Site used for horse riding	yes	no	
15	Site users include people with mobility problems	yes	no	
16	Site history of abuse [drunks, vandals, drugs, needle stick injury]	yes	no	
17	Site history of staff and/or volunteer intimidation	yes	no	
18	Fly-tipping	yes	no	
19	Unauthorised and/or authorised shooting [i.e. poaching/stalking]	yes	no	
20	Unauthorised vehicles [cars and motorbikes]	yes	no	
21	Difficult or restricted access / egress [esp. for heavy plant]	yes	no	
22	Authorised vehicles	yes	no	
23	Areas inaccessible to vehicles	yes	no	
24	Former landfill site	yes	no	
25	Proximity to public highway	yes	no	
26	Proximity to Public Rights of Way	yes	no	Yes
27	Overhead service lines	yes	no	
28	Underground service lines	yes	no	
29	Barbed wire	yes	no	
30	Personal hygiene facilities	yes	no	
31	Poisoning from blue / green algae	yes	no	
32	Exposure to bracken [ carcinogenic spores] (see CoP 15)	yes	no	
33	Puncture wounds [blackthorn / hawthorn]	yes	no	
34	Wild parsnip burns	yes	no	
35	Giant hogweed burns (see CoP 15)	yes	no	
36	Poisonous berries	yes	no	
37	Poisonous fungi	yes	no	
38	Standing dead wood	yes	no	
39	Risk of Weils' disease (see CoP 15)	yes	no	
40	Site known for wasps	yes	no	
41	Site known for bees	yes	no	
42	Site known for hornets	yes	no	
43	Site known for adders	yes	no	
44	Site known for stray dogs	yes	no	
45	Site known for ticks [Lyme disease] (see CoP 15)	yes	no	
46	Site known for allergens [pollen / spores]	yes	no	
47	Injury to pregnancy – exposure to lambs [listeria, chlamydia]	yes	no	

# Loddon Hazard Map, SU 7845 7569

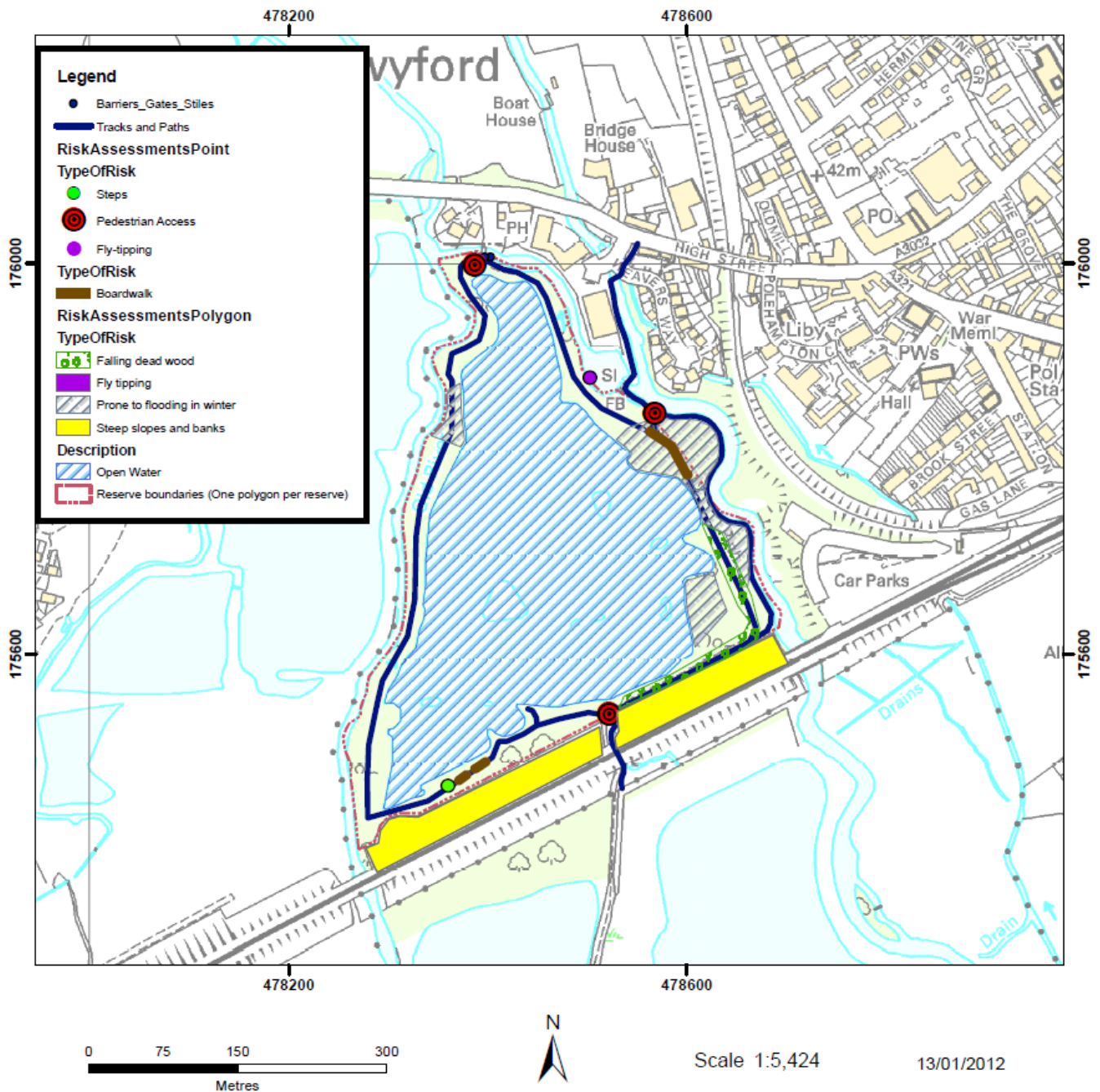

'This map is reproduced from the OS map by BBOWT with the permission of Ordnance Survey on behalf of The Controller of Her Majesty's Stationery Office, © Crown copyright. All rights reserved. Unauthorised reproduction infringes Crown Copyright and may lead to prosecution or civil proceedings. Berks, Bucks & Oxon Wildlife Trust Licence Number: 100026443, (2004). eMapSite Licence Number: 0100031673, (2007). APs ©Bluesky International and ©Infoterra Ltd. 2006 and ©Infoterra Ltd. 2010 Contains Ordnance Survey data © Crown copyright and database right 2010